

G E O R G I A

BATTLEFIELDS

Published by Georgia Battlefields Association, Inc., a non-profit organization dedicated to preservation of Georgia's Civil War history and sites. Contact newsletter editor by e-mail: info@georgiabattlefields.org

Resaca battlefield park opens 13 May – Reenactment 20-22 May

The Resaca Battlefield Historic Site will open with a ceremony at 3 p.m. on 13 May. The park entrance is just west of I-75 exit 320. (See March newsletter.) The site will be open only on Fridays, Saturdays, and Sundays for the foreseeable future. www.resacabattlefield.org

The following weekend, 20-22 May, is the annual Resaca reenactment, always one of the largest and best-run such events. www.georgiadivision.org/bor_reenactment.html

More of Mud Creek line in danger

Recovery of the housing market has led to several new developments in Cobb County. Last year, GBA and other local preservationists were able to protect 700 of 960 feet of the Mud Creek Line (June 2015 newsletter). Now, another section of the Mud Creek Line, occupied by Confederate forces 17-18 June 1864, is the subject of rezoning application Z-98, filed in September 2015. The application hearings before the Cobb Planning Commission and the Board of Commissioners were originally scheduled for December but have been postponed a few times and are now scheduled for 3 May (planning commission) and 17 May (full board).

The combined parcel of just under 24 acres includes the three properties at 2720, 2780, and 2782 Dallas Highway. It is bounded by Mud Creek on the west, Dallas Highway on the south, Garrison Commons on the east, and Garrison Ridge neighborhood on the north. The prospective development includes a shopping center and a senior living facility of eight buildings containing 50 units total.

Maps from the Atlas to Accompany the Official Records of the Union and Confederate Armies and also from a 1998 study conducted by EDAW for the National Park Service confirm that the Confederate line passed through the property. In November, the developer's attorney requested an archaeological report in response to earlier concerns expressed by local preservationists and GBA. Observation in March of the north end of the property indicated a trench remnant and three possible rifle pits, but we could not access the property itself.

In late March, local preservationists contacted the county commissioners and their planning representatives to express concern about the potential loss of earthworks. Many of the participants in GBA's 10-13 March tour led by Ed Bearss also mailed and e-mailed their concerns. We believe this increased the commissioners' awareness that Civil War sites were an attraction for not only Georgia residents but also drew out-of-state visitors to spend money in Cobb County since people from eleven states participated in the tour.

On 6 April, a local preservationist and a GBA rep met with the developer and his attorney to see if the site plan might be modified to preserve at least part of the earthworks on the property. The developer's representative indicated the site plan had been revised in draft several times, but the developer was having trouble reconciling the various objections raised not only by preservationists but also by surrounding neighborhood associations concerned about noise and traffic. We indicated our willingness to support some of the proposed revisions that minimized impact to the areas most likely to have earthworks; but an 18 April phone call from the developer's representative indicated they would be sticking with the original site plan.

Late on 28 April, GBA received the archaeology report, which had two conclusions of note: First, maps have contradicting locations for the Mud Creek Line in this area, with some indicating it passed to the east of the Z-98 property. Second, the earth disturbances on the site could be explained by prior agricultural use. GBA consulted the 1992 topographic map: If the line passed to the east, it will be the only example in which a line was built with higher ground immediately to its front; and while the trench remnants are not nearly as well-defined as other nearby sections of the line, they are consistent with where the line should be.

So, we now ask for your help again. Please contact the commissioners and their planning representatives to express support for preserving whatever earthworks remain. The property is in Cobb County District One, and the relevant district representative is usually accorded more influence, so please contact at least Skip Gunther and Bob Weatherford.

Planning commissioners' e-mails are:

Judy Williams judy.williams@cobbcounty.org

Skip Gunther skip.gunther@cobbcounty.org

Mike Terry mike.terry@cobbcounty.org

Christi Trombetti christi.trombetti@cobbcounty.org

Galt Porter galt.porter@cobbcounty.org

County commissioners' e-mails are:

Tim Lee tlee@cobbcounty.org

Bob Weatherford bob.weatherford@cobbcounty.org

Bob Ott bob.ott@cobbcounty.org

JoAnn Birrell joann.birrell@cobbcounty.org

Lisa Cupid lisa.cupid@cobbcounty.org

Please copy county historic preservation planner Mandy Elliott mandy.elliott@cobbcounty.org.

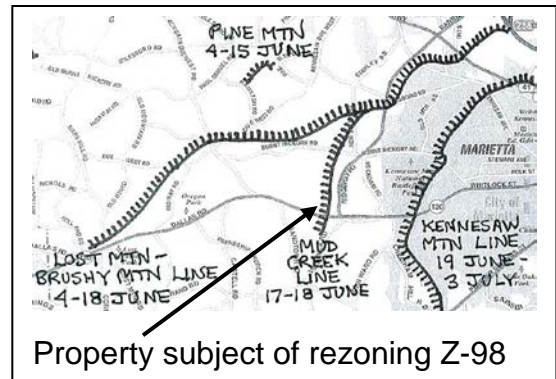

Z-98 site plan

Senior living residences

Shopping center

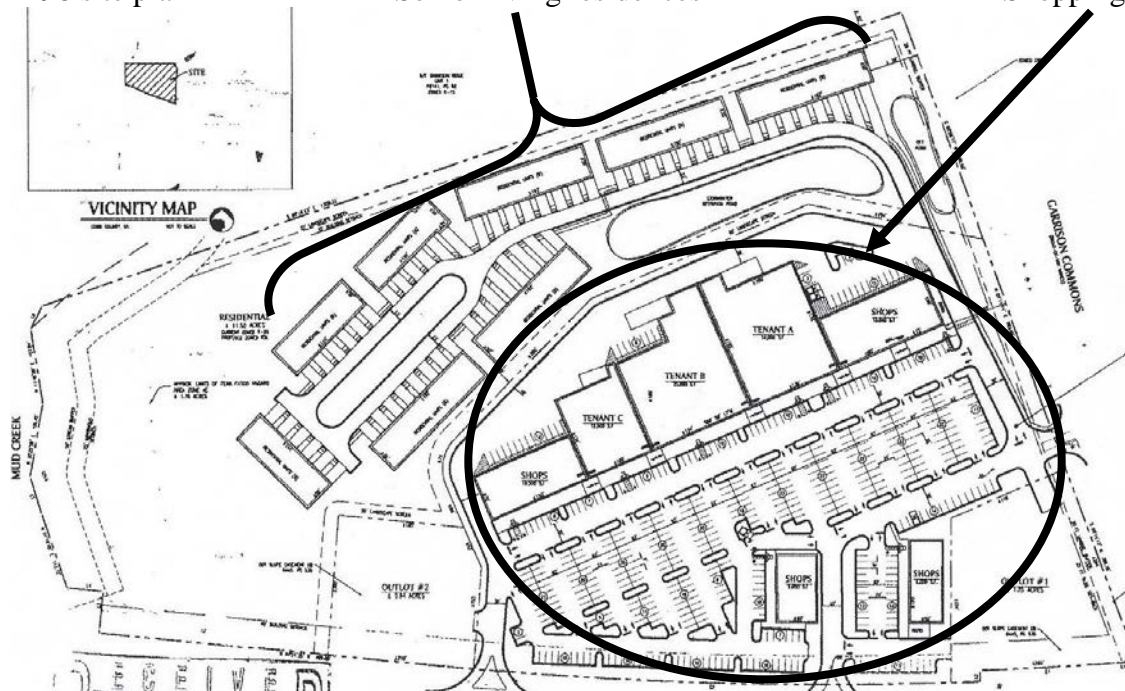

GBA helps Shenandoah Valley Battlefields Foundation conference

On 9 April, GBA helped lead a tour for the Shenandoah Valley Battlefields Foundation conference, held this year in Marietta. The overall topic was the conduct and effects of the 1864 Valley Campaign and Atlanta Campaign. The objective was not only to help another preservation organization but also to help participants understand the Atlanta Campaign and to see the state of preservation of some of its battlefields. GBA helped with the River Line and Peachtree Creek tour, during which we showed sites that had been heavily affected by development, in contrast to what the group had seen at Pickett's Mill and Kennesaw Mountain.

Photo: Mike Shaffer of the River Line Historic Area and Charlie Crawford of GBA take the group to Casey's Hill, showing the Confederate position after withdrawal from the River Line and before the Battle of Peachtree Creek. Photo by Janice Hannah.



Georgia Battlefields Association

P.O. Box 589

Tate GA 30177- 0589

www.georgiabattlefields.org

May 2016

Address correction requested

Return postage guaranteed